

Attachment B6

Selected Drawings – Buildings A, B and C



THIS DRAWING COMPRISE AND SHALL REMAIN THE PROPERTY OF FENDER KATSALIDIS (AUSTRALIA) PTY LTD
OTHER THAN BY FULL DISBURSEMENT DIRECT FROM TO COMMERCE WORK OWNERS (RESIDENT)
DRAWING NO. 130 JOYNTON AVENUE, ZETLAND BASINCHUTE BASMENT 02 - BLDG C
DATE 23/08/20

DATE 23/08/20

DATE 23/08/20

DATE 23/08/20

DATE 23/08/20

DATE 23/08/20

DATE 23/08/20

DATE 23/08/20

DATE 23/08/20

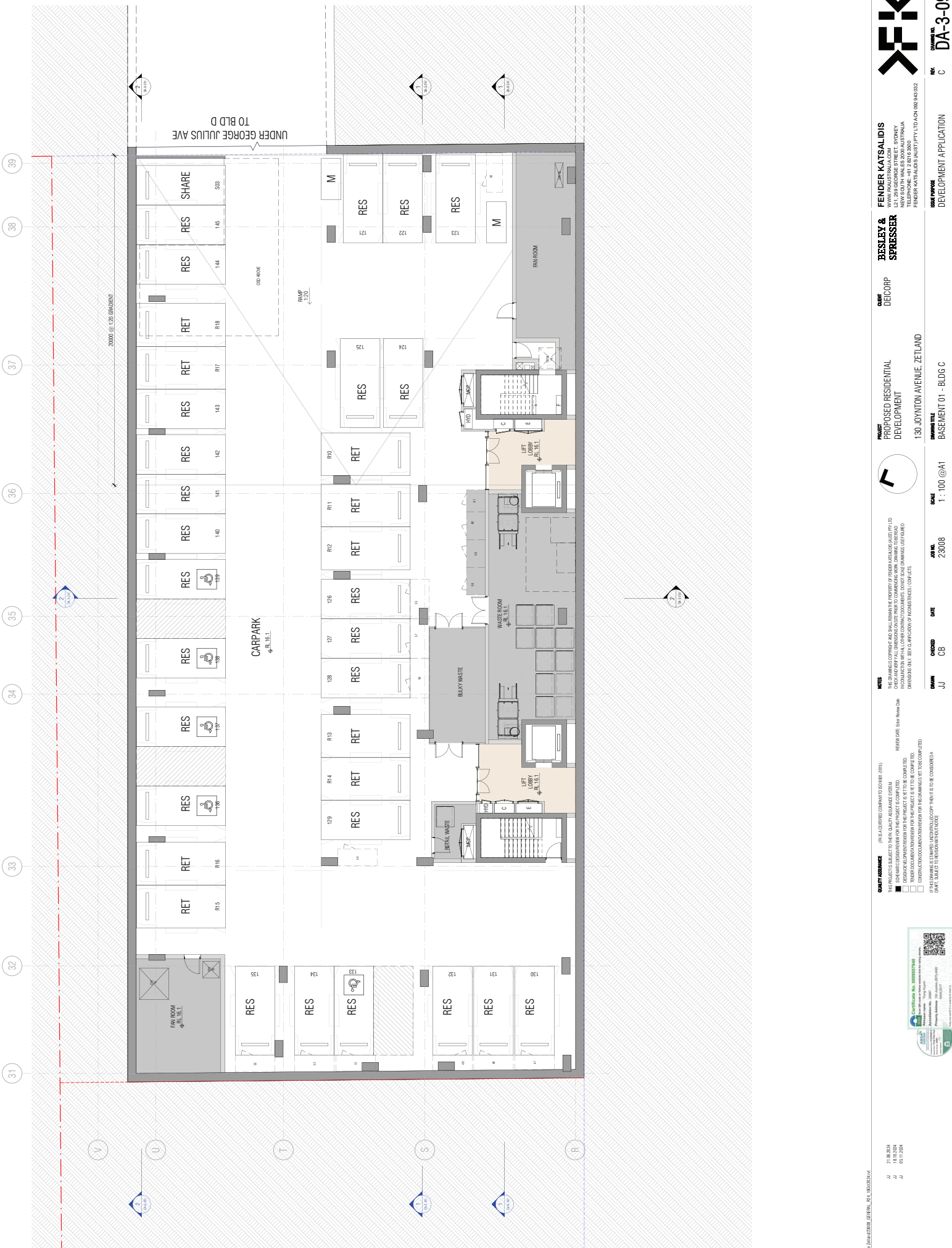

A:\Projects\172018_130 JOYNTON AVENUE_ZETLAND\DWG\REV_02.dwg, 18/02/2024
REVISIONS
 A DEVELOPING APPLICATION 21/08/24 JJ
 B FOR SUBMISSION 08/09/24 JJ
 C FOR SUBMISSION 08/10/24 JJ

NOTES
 (1) IS A CERTIFIED COMPANY (ISO 9001: 2015)
 THE PROJECT IS SUBJECT TO THEIR QUALITY ASSURANCE SYSTEM
 REVISION DATE: 08/10/24
 DESIGN AND CONSTRUCTION FOR THE PRODUCT TO BE COMPLETED
 CONSTRUCTION DOCUMENTATION FOR THE PRODUCT TO BE COMPLETED
 IT IS THE OWNER'S OBLIGATION TO OBTAIN NECESSARY PERMITS FOR THE PRODUCT TO BE COMPLETED
 DON'T SUBJECT TO RETAINING CONTRACTS

QUALITY ASSURANCE
 (1) IS A CERTIFIED COMPANY (ISO 9001: 2015)
 THE PROJECT IS SUBJECT TO THEIR QUALITY ASSURANCE SYSTEM
 REVISION DATE: 08/10/24
 DESIGN AND CONSTRUCTION FOR THE PRODUCT TO BE COMPLETED
 CONSTRUCTION DOCUMENTATION FOR THE PRODUCT TO BE COMPLETED
 IT IS THE OWNER'S OBLIGATION TO OBTAIN NECESSARY PERMITS FOR THE PRODUCT TO BE COMPLETED
 DON'T SUBJECT TO RETAINING CONTRACTS

OWNER JJ
DESIGNER CB
DATE 23/08/24
SCALE 1:100 @A1
PROJECT PROPOSED RESIDENTIAL DEVELOPMENT
PHASE 01 - BLDG C
130 JOYNTON AVENUE, ZETLAND

RESILV & SPRESSER
 130 JOYNTON AVENUE, ZETLAND
 TEL: 02 9510 3000
 WWW.PAUSAUTRALIA.COM

FENDER KATSALIDIS
 131, 250 GEORGE STREET, SYDNEY
 TEL: 02 9251 3000
 WWW.FK.COM.AU

DA-3-099
 DEVELOPMENT APPLICATION



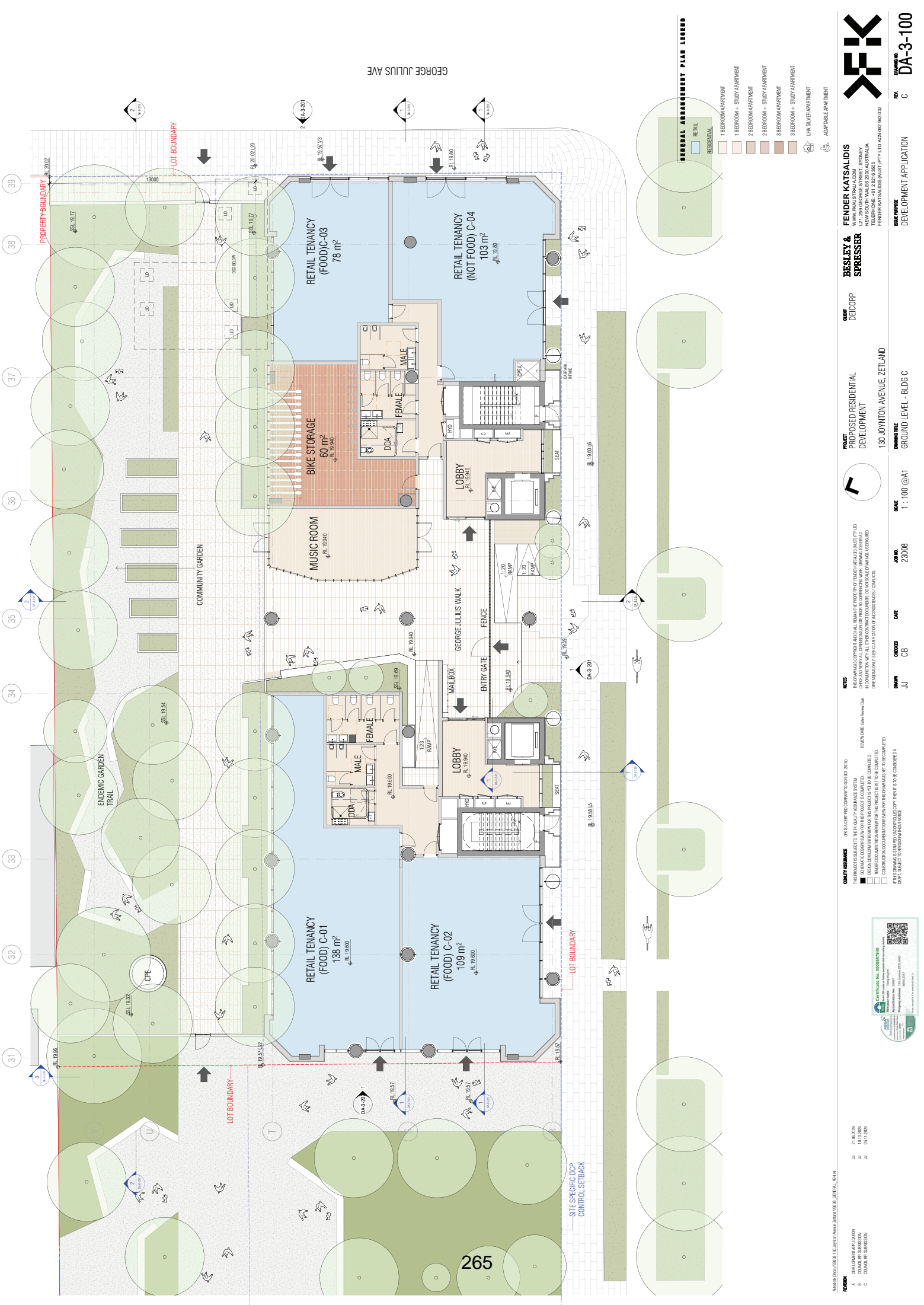

31 32 33 34 35 36 37 38 39

GEORGE JULIUS AVE

REVISIONS

A	DEVELOPER APPLICATION	21.08.2024	JJ
B	COMMITTEE SUBMISSION	08.10.2024	JJ
C	COUNCIL SUBMISSION	08.10.2024	JJ

AMOUNT: D001 (7/2024) 13 JOYNTON AVENUE ZETLAND (2752) SITE PLAN - 02/14

QUALITY ASSURANCE (P16 IS A CERTIFIED COMPANY FOR ISO 9001:2015)
 THE PROJECT IS SUBJECT TO THEIR QUALITY ASSURANCE SYSTEM
 CHECK AND APPROVE ALL DIMENSIONS PRIOR TO COMMENCEMENT WORK
 CONFIRMATION OF DIMENSIONS FOR THE PROJECT IS SET TO BE COMPLETED
 CONFIRMATION OF DIMENSIONS FOR THE PROJECT IS SET TO BE COMPLETED
 CONFIRMATION OF DIMENSIONS FOR THE PROJECT IS SET TO BE COMPLETED
 CONFIRMATION OF DIMENSIONS FOR THE PROJECT IS SET TO BE COMPLETED
 THIS DRAWING IS A PRELIMINARY DEVELOPMENT PLAN AND IS NOT TO BE CONSIDERED A CONTRACT DOCUMENT
 DON'T SUBJECT TO RETROWORK IN TAKE

NOTES
 THE DRAWING IS FOR INFORMATION AND IS NOT TO BE USED FOR CONSTRUCTION
 CHECK AND APPROVE ALL DIMENSIONS PRIOR TO COMMENCEMENT WORK
 CONFIRMATION OF DIMENSIONS FOR THE PROJECT IS SET TO BE COMPLETED
 CONFIRMATION OF DIMENSIONS FOR THE PROJECT IS SET TO BE COMPLETED
 CONFIRMATION OF DIMENSIONS FOR THE PROJECT IS SET TO BE COMPLETED
 CONFIRMATION OF DIMENSIONS FOR THE PROJECT IS SET TO BE COMPLETED

PROPERTY 130 JOYNTON AVENUE, ZETLAND

PROJECT PROPOSED RESIDENTIAL DEVELOPMENT

CLIENT DECORP

DESIGNER RESLEY & SPRESSER

ARCHITECT FENDER KATSALIDIS

SCALE 1:100 @A1

DATE 23/08/24

DRAWN JJ

CHECKED CB

DATE 23/08/24

PROJECT NO. 23008

GROUND LEVEL - BLDG C

GENERAL ARRANGEMENT PLAN LEGEND

- 1 BEDROOM APARTMENT
- 1 BEDROOM + STUDY APARTMENT
- 2 BEDROOM APARTMENT
- 2 BEDROOM + STUDY APARTMENT
- 3 BEDROOM APARTMENT
- 3 BEDROOM + STUDY APARTMENT
- LUX SILVER APARTMENT
- ADAPTABLE # APARTMENT

FENDER KATSALIDIS
 WWW.FKARCHITECTURE.COM
 U1, 2/5 GEORGE STREET, SYDNEY
 NEW SOUTH WALES, AUSTRALIA
 TELEPHONE +61 2 870 3300
 FENDER KATSALIDIS (AUSTRALIA) PTY LTD ACR 002 943 032

RESLEY & SPRESSER

DA-3-100

DEVELOPMENT APPLICATION

DA-3-100



265

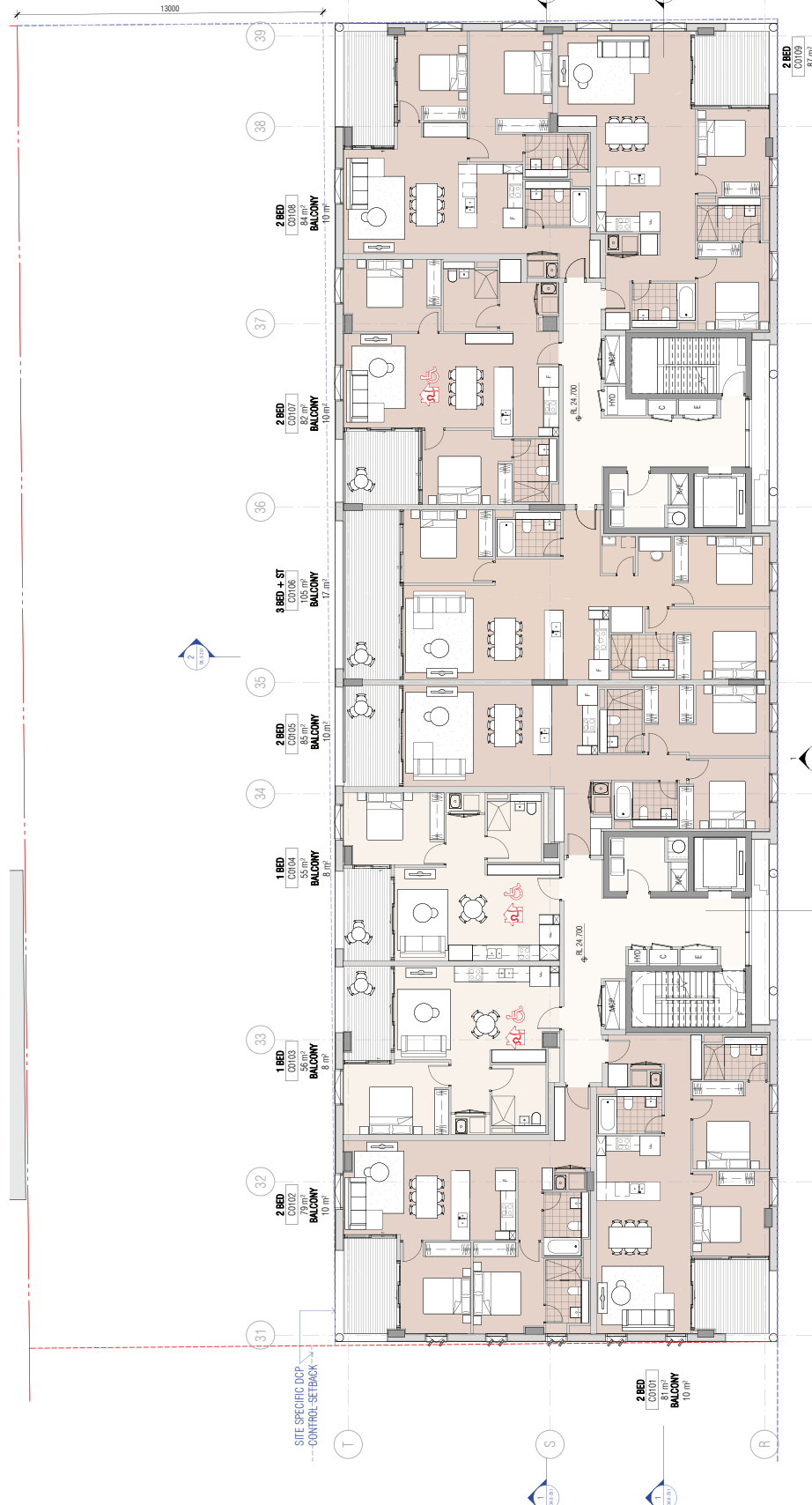

NOTE: CORNER BALCONIES ABOVE LEVEL 05 ARE TO HAVE A GLASS SCREEN BEHIND THE RAILING TO ASSIST IN WIND MITIGATION
 ALL ARCHITECTURAL FEATURES AND SHADING DEVICES FROM LEVEL 1 AND ABOVE (EXCLUDING LEVEL 01 WIND CANOPIES) ARE TO EXTEND NO FURTHER THAN 450MM OVER THE LOT BOUNDARY.

GENERAL ARRANGEMENT PLAN LEGEND

- RETAIL
- ESSENTIAL
- 1 BEDROOM APARTMENT
- 1 BEDROOM + STUDY APARTMENT
- 2 BEDROOM APARTMENT
- 2 BEDROOM + STUDY APARTMENT
- 3 BEDROOM APARTMENT
- 3 BEDROOM + STUDY APARTMENT
- LUX SILVER APARTMENT
- ADAPTABLE APARTMENT

FENDER KATSAIDIS
 WWW.FENDERKATSAIDIS.COM
 U1, U3, 200 GEORGE STREET, SYDNEY
 U1, U3, 200 GEORGE STREET, SYDNEY
 FENDER KATSAIDIS PARTNERSHIP PTY LTD ACN 092 940 932
 TELEPHONE +61 2 8270 3300

RESLEY & SPRESSER
 ARCHITECTS
 130 JOYNTON AVENUE, ZETLAND
 LEVEL 01-05 - BLDG C

CLIENT
 DEICORP

PROJECT
 PROPOSED RESIDENTIAL DEVELOPMENT

DATE
 23/08/2024

SCALE
 AS INDICATED @A1

PHASE
 DEVELOPMENT APPLICATION

REF.
 DA-3-101

QUALITY ASSURANCE (IN A CERTIFIED COMPANY TO ISO 9001:2015)
 THIS PROJECT IS SUBJECT TO THEIR QUALITY ASSURANCE SYSTEM
 DESIGN DOCUMENTATION FOR THE PROJECT IS SET TO BE COMPLETED
 CONSTRUCTION DOCUMENTATION FOR THE PROJECT IS SET TO BE COMPLETED
 IF THIS CHANGE IS DETERMINED TO BE NECESSARY, THE PROJECT IS TO BE CONSIDERED AS SUBJECT TO REVIEW AND APPROVAL

REVISION DATE: 23/08/2024

REVISION: 01

DATE: 23/08/2024

BY: JJ

CB

DATE: 23/08/2024

BY: JJ

NOTES
 THE DRAWING IS FOR INFORMATION ONLY AND DOES NOT REPRESENT THE PROPERTY OF FENDER KATSAIDIS PARTNERSHIP LTD OR ANY OTHER PARTY. ALL INFORMATION IS SUBJECT TO CHANGE WITHOUT NOTICE. ANY INFORMATION IS SUBJECT TO CHANGE WITHOUT NOTICE. ANY INFORMATION IS SUBJECT TO CHANGE WITHOUT NOTICE.

DATE: 23/08/2024

BY: JJ

CB

DATE: 23/08/2024

BY: JJ

DATE: 23/08/2024

BY: JJ

CB

DATE: 23/08/2024

BY: JJ

DATE: 23/08/2024

BY: JJ

CB

DATE: 23/08/2024

BY: JJ

DATE: 23/08/2024

BY: JJ

CB

DATE: 23/08/2024

BY: JJ

DATE: 23/08/2024

BY: JJ

CB

DATE: 23/08/2024

BY: JJ

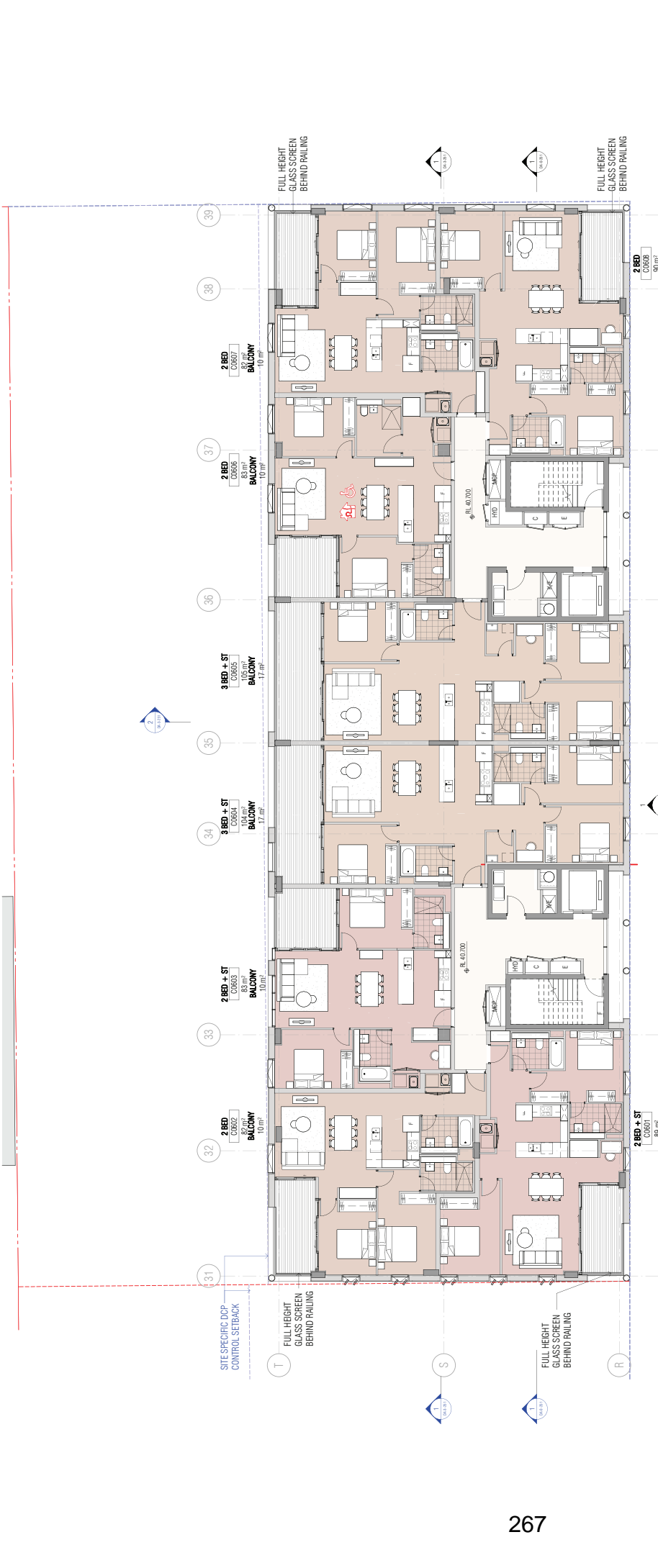

NOTE: CORNER BALCONIES ABOVE LEVEL 05 ARE TO HAVE A GLASS SCREEN BEHIND THE RAILING TO ASSIST IN WIND MITIGATION
 ALL ARCHITECTURAL FEATURES AND SHADING DEVICES FROM LEVEL 1 AND ABOVE (EXCLUDING LEVEL 01 WIND CANOPIES) ARE TO EXTEND NO FURTHER THAN 4500MM OVER THE LOT BOUNDARY.

- GENERAL ARRANGEMENT PLAN LEGEND**
- RETAIL
 - RESIDENTIAL
 - 1 BEDROOM APARTMENT
 - 1 BEDROOM + STUDY APARTMENT
 - 2 BEDROOM APARTMENT
 - 2 BEDROOM + STUDY APARTMENT
 - 3 BEDROOM APARTMENT
 - 3 BEDROOM + STUDY APARTMENT
 - LUX SILVER APARTMENT
 - ADAPTABLE # APARTMENT

FENDER KATSALIDIS
 WWW.FKARCHITECTURE.COM
 U1, 201 GEORGE STREET, SYDNEY
 NSW 2000, AUSTRALIA
 TELEPHONE: +61 2 870 3300
 FENDER KATSALIDIS (AUSTRALIA) PTY LTD ACN 092 943 032

RESLEY & SPRESSER
 CLAYD
 DECORP

PROPOSED RESIDENTIAL DEVELOPMENT
 130 JOYNTON AVENUE, ZETLAND
 PHASE 01
 LEVEL 06-07 - BLDG C

DATE: 23/08/2024
SCALE: AS INDICATED @A1
DATE: 23/08/2024
SCALE: AS INDICATED @A1
DATE: 23/08/2024
SCALE: AS INDICATED @A1

QUALITY ASSURANCE (IN A CERTIFIED COMPANY TO ISO 9001:2015)
 THIS PROJECT IS SUBJECT TO THEIR QUALITY ASSURANCE SYSTEM
 DESIGN DEVELOPMENT REVIEW FOR THE PROJECT IS TO BE COMPLETED
 CONSTRUCTION DOCUMENTATION REVIEW FOR THE PROJECT IS TO BE COMPLETED
 IT IS THE OWNER'S OBLIGATION TO MONITOR THE PROJECT TO BE COMPLETED
 OWNER IS SUBJECT TO RETURN WITHIN 14 DAYS

NOTES
 THE DRAWING IS FOR INFORMATION AND SHALL REMAIN THE PROPERTY OF FENDER KATSALIDIS (AUSTRALIA) PTY LTD
 OTHER AND NOT TO BE REPRODUCED OR USED FOR ANY OTHER PROJECT WITHOUT THE WRITTEN PERMISSION OF FENDER KATSALIDIS (AUSTRALIA) PTY LTD
 FOR INFORMATION OF THE CLIENT, FENDER KATSALIDIS (AUSTRALIA) PTY LTD IS NOT A REGISTERED ARCHITECT UNDER THE ARCHITECTURE ACT 2005
 FOR INFORMATION OF THE CLIENT, FENDER KATSALIDIS (AUSTRALIA) PTY LTD IS NOT A REGISTERED ARCHITECT UNDER THE ARCHITECTURE ACT 2005

PROJECT INFORMATION
 PROJECT: PROPOSED RESIDENTIAL DEVELOPMENT
 ADDRESS: 130 JOYNTON AVENUE, ZETLAND
 PHASE: PHASE 01
 LEVEL: LEVEL 06-07 - BLDG C
 DATE: 23/08/2024
 SCALE: AS INDICATED @A1
 DATE: 23/08/2024
 SCALE: AS INDICATED @A1

CLIENT
 RESLEY & SPRESSER
 CLAYD
 DECORP

DESIGNER
 FENDER KATSALIDIS (AUSTRALIA) PTY LTD
 U1, 201 GEORGE STREET, SYDNEY
 NSW 2000, AUSTRALIA
 TELEPHONE: +61 2 870 3300
 FENDER KATSALIDIS (AUSTRALIA) PTY LTD ACN 092 943 032

ARCHITECT
 RESLEY & SPRESSER
 CLAYD
 DECORP

DATE
 23/08/2024

DATE
 23/08/2024

DATE
 23/08/2024

DATE
 23/08/2024

DATE
 23/08/2024

DATE
 23/08/2024

DATE
 23/08/2024

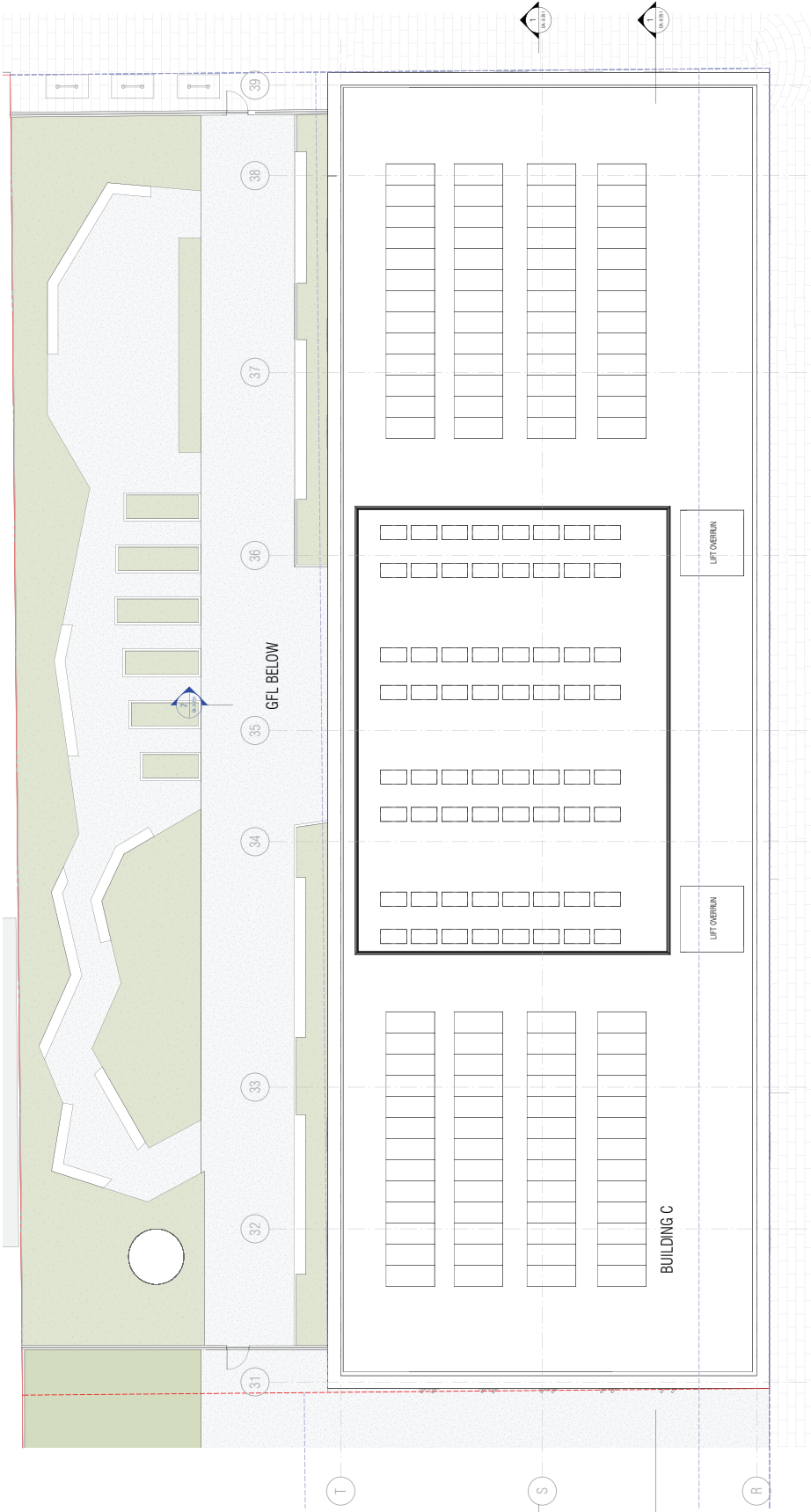

AMURR Doc: 07/2018 130 JOYNTON AVENUE ZETLAND (25/08)_GFL BLDG_C

REV
 A DEVELOPER APPLICATION 21/08/24
 B CONSULTATION 18/10/24



QUALITY ASSURANCE (P16 IS A CERTIFIED COMPANY TO ISO 9001:2015)
 THIS PROJECT IS SUBJECT TO THEIR QUALITY ASSURANCE SYSTEM
 DESIGN DOCUMENTATION FOR THE PROJECT IS COMPLETE
 DESIGN DOCUMENTATION FOR THE PROJECT IS SET TO BE COMPLETED
 CONSTRUCTION DOCUMENTATION FOR THE PROJECT IS SET TO BE COMPLETED
 IF THIS DRAWING IS ISSUED, THE CONTRACTOR SHALL BE RESPONSIBLE FOR THE QUALITY OF THE WORK AND SHALL BE SUBJECT TO RETENTION OF FUNDS

NOTES
 THE DRAWING IS FOR INFORMATION AND SHALL REMAIN THE PROPERTY OF FENDER KATSAIDIS (P16) LTD
 NO PART OF THIS DRAWING IS TO BE REPRODUCED OR TRANSMITTED IN ANY FORM OR BY ANY MEANS
 WITHOUT THE WRITTEN PERMISSION OF FENDER KATSAIDIS (P16) LTD

DATE 23/08/24
SCALE 1:100 @A1
PROJECT PROPOSED RESIDENTIAL DEVELOPMENT
CLIENT DECORP
DESIGNER RESJEV & SPRESSER
ADDRESS 130 JOYNTON AVENUE, ZETLAND
PROJECT NO. ROOF - BLDG C

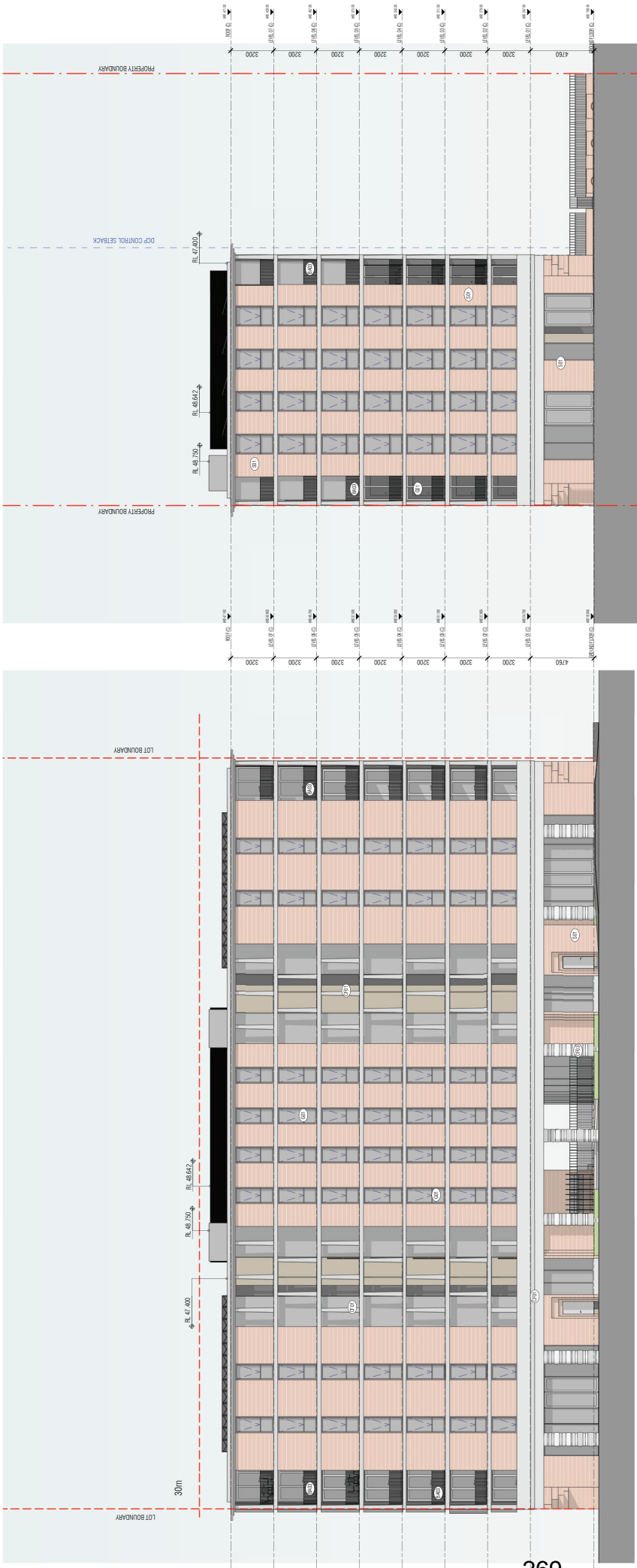

EXTERIOR MATERIAL LEGEND KEY

- (S1) Terracotta tiles in a square format inlaid to precast panel wall
- (S2) Off form concrete expressed slab edge
- (S3) Off form concrete with expressed timber formliner finish
- (S4) Off form concrete columns to upper facade and balconies
- (S5) Off form concrete column with profiled ribbed formliner
- (S6) Metal palisade type balustrade, silver finish
- (S7) Neutral glazing

AMW/01/2018 (P) JAMES ANNE JAMES (P) 01 8361 01 14

REVISION
A DEVELOPER APPROVAL
B CONSULTING ENGINEER

DATE
21.08.24
18.03.24



QUALITY ASSURANCE (P) IS A CERTIFIED COMPANY (ISO 9001: 2015)
THIS PROJECT IS SUBJECT TO THEIR QUALITY ASSURANCE SYSTEM
FOR THIS PROJECT, THE PROJECT IS TO BE COMPLETED
CONSTRUCTION COMMENCEMENT DATE FOR THIS PROJECT IS TO BE COMPLETED
IF THIS DRAWING IS MARKED 'UNDER DEVELOPMENT' THEN IT IS TO BE CONSIDERED
DRAFT SUBJECT TO REVIEW AND CONFIRMATION

NOTES
THE DRAWING(S) CORRECT AND SHALL REMAIN THE PROPERTY OF FENDER KATSALIDIS (AUSTRALIA) PTY LTD OR ANY OTHER PARTY FULLY ENDORSING OR IN CONTACT WITH COMMERCIAL WORK OWNERS (RESIDENTIAL DEVELOPERS) ONLY. BEHALF EMPLOYER OF FENDER KATSALIDIS (AUSTRALIA) PTY LTD

DATE: 23/08/2018
DATE: 23/08/2018
DATE: 23/08/2018

CLIENT: DECORP
PROJECT: PROPOSED RESIDENTIAL DEVELOPMENT
PROJECT SITE: 130 JOYNTON AVENUE, ZETLAND
PROJECT NAME: ZETLAND AVE ELEVATION(SOUTH) & GEORGE JULIUS AVE ELEVATION(EAST)

DESIGNER: RESILVY & SPRESSER
ARCHITECT: FENDER KATSALIDIS (AUSTRALIA) PTY LTD
ADDRESS: 130 JOYNTON AVENUE, ZETLAND

FENDER KATSALIDIS
WWW.FKATSA.COM
L1, 250 GEORGE STREET, SYDNEY
NEW SOUTH WALES, AUSTRALIA
TELEPHONE: +61 2 8210 3300
FAX: +61 2 8210 3300

DA-3-201
REV: B
DATE: 18/03/24

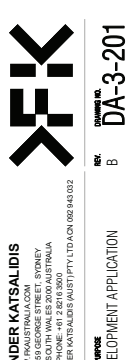

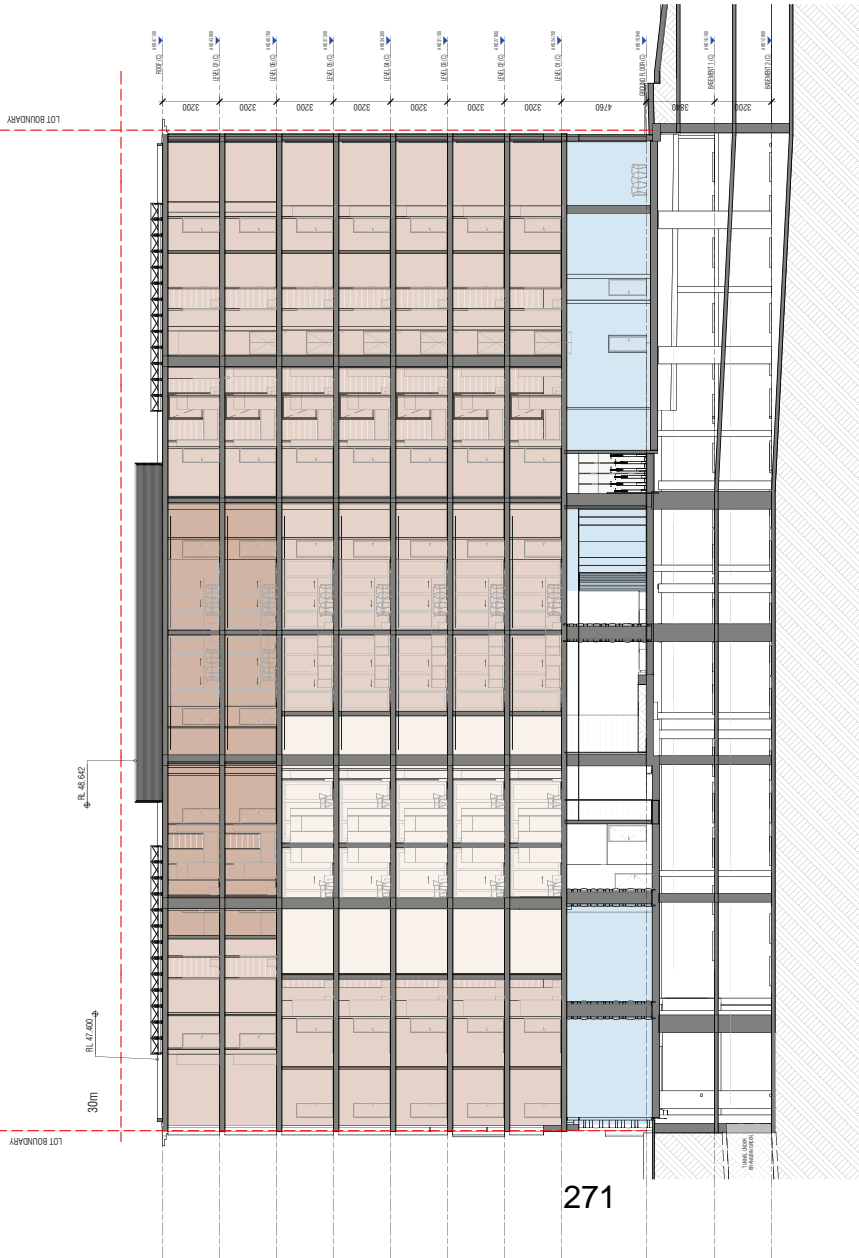

271

1 DA SECTION A - BUILDING C

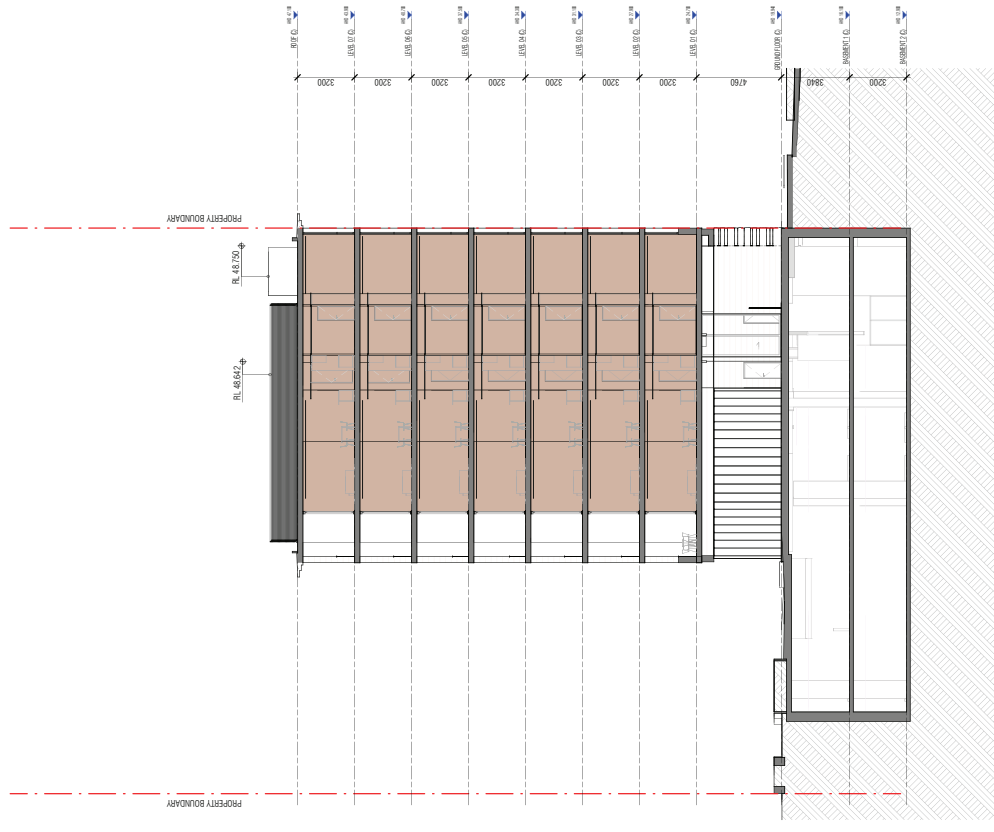

2 DA SECTION B - BUILDING C

GENERAL ARRANGEMENT SECTION LEGEND

RETAIL	RESIDENTIAL
1 BEDROOM APARTMENT	2 BEDROOM APARTMENT
3 BEDROOM APARTMENT	

PROJECT PROPOSED RESIDENTIAL DEVELOPMENT
CLIENT DECORP
DATE 23/08/24
PROJECT NO. 130 JOYNTON AVENUE, ZETLAND
SECTION SECTION A & B
SCALE 1:150 @A1
DATE 23/08/24
DESIGNED BY CB
CHECKED BY PB
DATE 23/08/24

NOTES
 THE DRAWING IS FOR INFORMATION ONLY. THE CLIENT IS RESPONSIBLE FOR OBTAINING ALL NECESSARY PERMITS AND APPROVALS FROM THE LOCAL COUNCIL AND OTHER RELEVANT AUTHORITIES.
 THE CLIENT IS RESPONSIBLE FOR OBTAINING ALL NECESSARY PERMITS AND APPROVALS FROM THE LOCAL COUNCIL AND OTHER RELEVANT AUTHORITIES.
 THE CLIENT IS RESPONSIBLE FOR OBTAINING ALL NECESSARY PERMITS AND APPROVALS FROM THE LOCAL COUNCIL AND OTHER RELEVANT AUTHORITIES.

QUALITY ASSURANCE (IN A CAPTURED COMPANY TO ISO 9001:2015)
 THE PROJECT IS SUBJECT TO THEIR QUALITY ASSURANCE SYSTEM.
 DESIGN DEVELOPMENT REVIEW FOR THE PROJECT IS COMPLETE.
 DESIGN DEVELOPMENT REVIEW FOR THE PROJECT IS SET TO BE COMPLETED.
 CONSTRUCTION DOCUMENTATION FOR THE PROJECT IS SET TO BE COMPLETED.
 IF THE DRAWING IS ESTIMATED TO BE USED FOR CONSTRUCTION, THE CLIENT IS TO BE CONSIDERED AS THE RESPONSIBLE PARTY FOR THE PROJECT.

REVISIONS
 NO. | DATE | DESCRIPTION
 01 | 21/08/24 | INITIAL DESIGN
 02 | 18/02/24 | REVISED DESIGN

PROJECT INFORMATION
 DEVELOPER: DECORP
 CONSULTANT: BARRINGTON
 PROJECT NO.: 130 JOYNTON AVENUE, ZETLAND
 PROJECT ADDRESS: 130 JOYNTON AVENUE, ZETLAND
 PROJECT CONTACT: 08 8333 3333
 PROJECT WEBSITE: WWW.PKPROJECTS.COM

DESIGNER INFORMATION
 FENDER KATSALIDIS ARCHITECTS PTY LTD
 1/111 GEORGE STREET, SYDNEY
 NSW 2000, AUSTRALIA
 TELEPHONE: +61 2 8270 3300
 WWW.FENDERKATSALIDIS.COM

LEGAL INFORMATION
 DEVELOPMENT APPLICATION NO. DA-3-251
 SECTION B

FFK



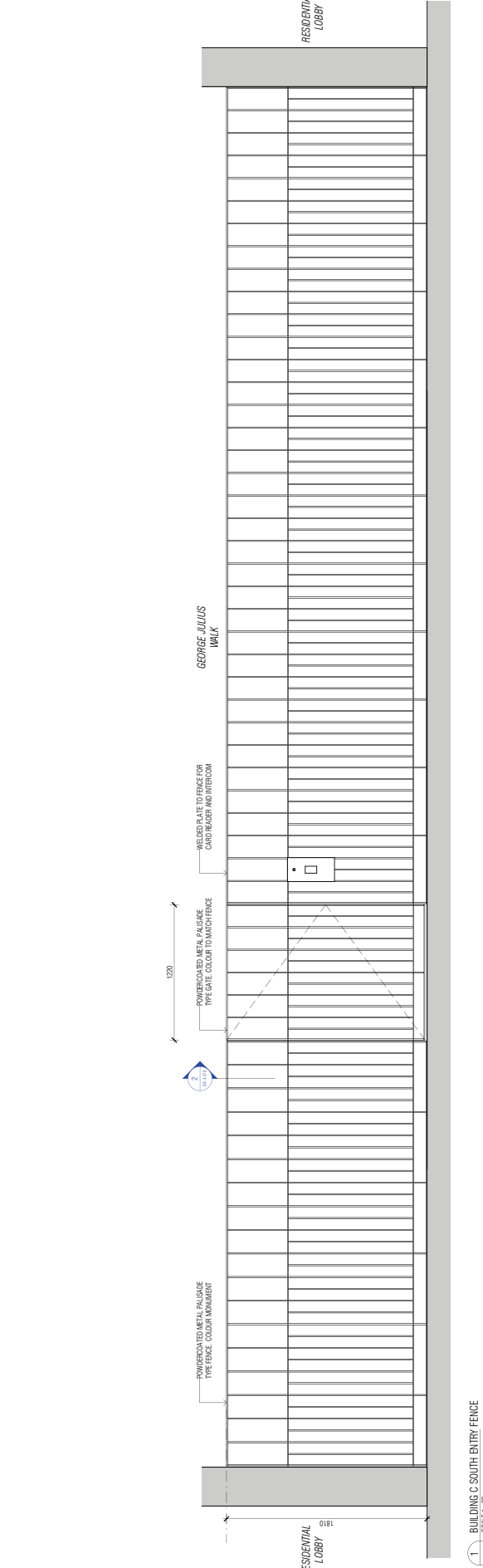
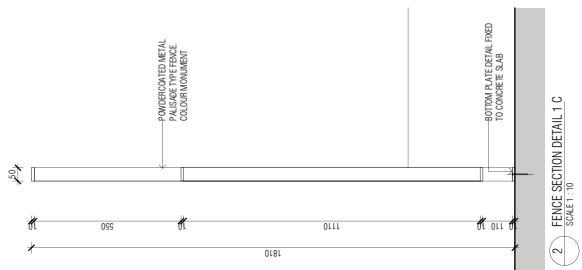

2 FENCE SECTION DETAIL 1 C
SCALE: 1:10

1 BUILDING C SOUTH ENTRY FENCE
SCALE: 1:20

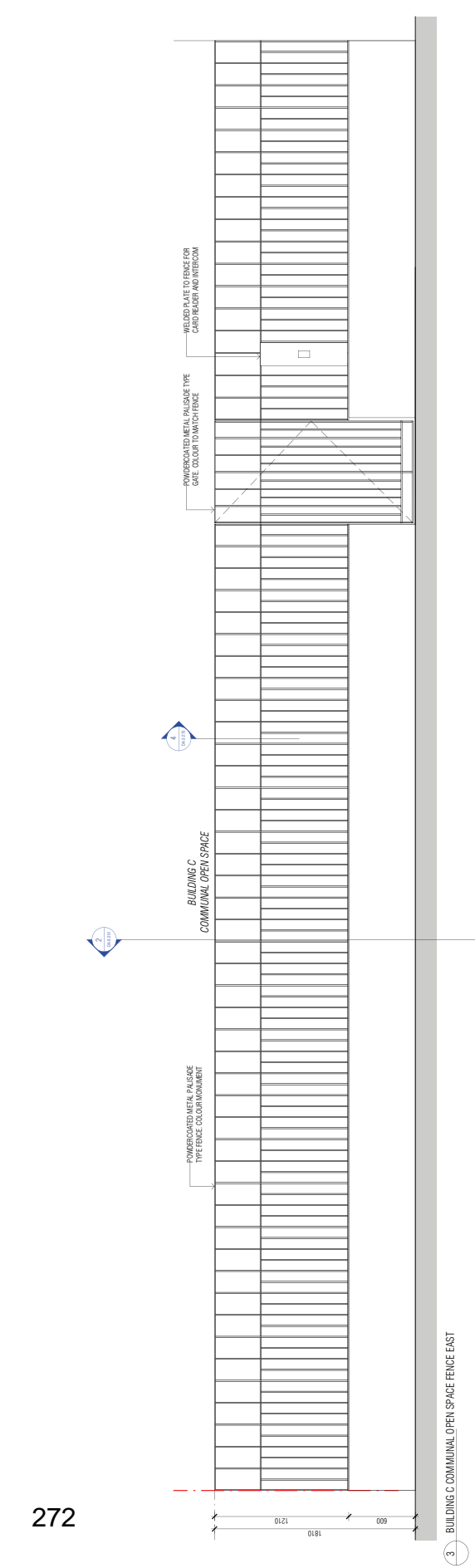
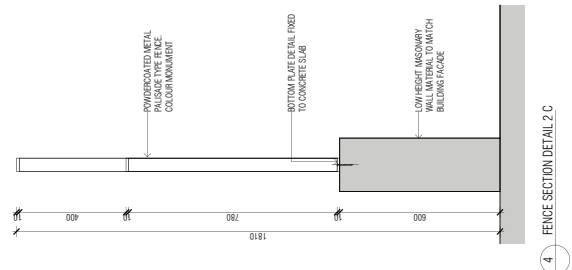

4 FENCE SECTION DETAIL 2 C
SCALE: 1:10

3 BUILDING C COMMUNAL OPEN SPACE FENCE EAST
SCALE: 1:20

PROJECT: PROPOSED RESIDENTIAL DEVELOPMENT
ADDRESS: 130 JOYNTON AVENUE, ZETLAND
CLIENT: DEICORP
DESIGNER: RESLEY & SPRESSER
DATE: 18.03.2024
SCALE: AS INDICATED @A1
DATE: 23.08.2024
PROJECT NO.: DA-3-270

NOTES:
 1. THIS PROJECT IS SUBJECT TO THEIR QUALITY ASSURANCE SYSTEM.
 2. DESIGN AND CONSTRUCTION SHALL BE IN ACCORDANCE WITH THE PRODUCT SPECIFICATIONS.
 3. CONSTRUCTION SHALL BE IN ACCORDANCE WITH THE PRODUCT SPECIFICATIONS.
 4. THIS DRAWING IS A PRELIMINARY DESIGN AND SHALL BE SUBJECT TO CHANGE WITHOUT NOTICE.

QUALITY ASSURANCE: (IN ACCORDANCE WITH ISO 9001:2015)
 THE PROJECT IS SUBJECT TO THEIR QUALITY ASSURANCE SYSTEM.
 DESIGN AND CONSTRUCTION SHALL BE IN ACCORDANCE WITH THE PRODUCT SPECIFICATIONS.
 CONSTRUCTION SHALL BE IN ACCORDANCE WITH THE PRODUCT SPECIFICATIONS.
 THIS DRAWING IS A PRELIMINARY DESIGN AND SHALL BE SUBJECT TO CHANGE WITHOUT NOTICE.

RESLEY & SPRESSER
 130 JOYNTON AVENUE, ZETLAND
 TEL: 08 8333 3300
 WWW.PAULSTRA.COM

FENDER KATSALIDIS
 130 JOYNTON AVENUE, ZETLAND
 TEL: 08 8333 3300
 WWW.PAULSTRA.COM

FENDER KATSALIDIS (AUSTRALIA) PTY LTD AON 002 943 032

AOMD: Doc: 07/2018 EP JOHN AVENUE ZETLAND (2) REV: 04/24
 A COMOL W. SUBANSON
 AJ 18.03.2024

QR CODE:

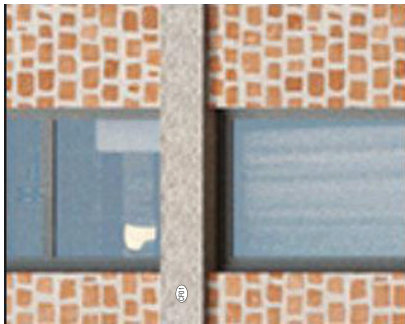
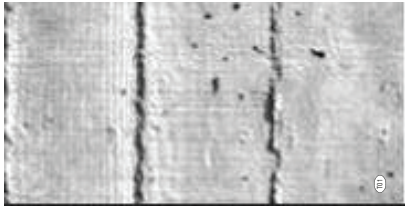
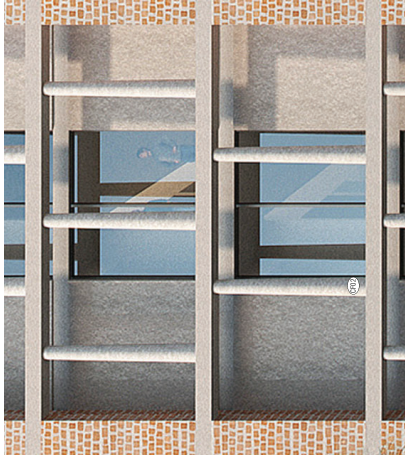

EXTERIOR MATERIAL LEGEND KEY

- ① Terracotta tiles in a square format
- ② Off form concrete expressed slab edge
- ③ Off form concrete with expressed timber formliner finish
- ④ Off form concrete columns to upper facade and balconies
- ⑤ Off form concrete column with profiled ribbed formliner
- ⑥ Metal palisade type balustrade, silver colour finish
- ⑦ Neutral glazing

AMURIS DATE: 07/2024 | 13, Jovnton Avenue, Zetland | 23008 | 02 9416 1214

REVISION
 A DEVELOPING APPLICATION
 B COMPLETION SUBMISSION

DATE
 21.09.24
 18.10.24



QUALITY ASSURANCE (IN A CERTIFIED COMPANY FOR ISO 9001: 2015)
 THIS PROJECT IS SUBJECT TO THEIR QUALITY ASSURANCE SYSTEM
 YES (FOR THIS PROJECT) FOR THE PROJECT IS SET TO BE COMPLETED
 YES (FOR THIS PROJECT) FOR THE PROJECT IS SET TO BE COMPLETED
 YES (FOR THIS PROJECT) FOR THE PROJECT IS SET TO BE COMPLETED
 IF THIS DRAWING IS SUBMITTED TO THE LOCAL GOVERNMENT FOR THE PROJECT IS SET TO BE COMPLETED
 IT MUST BE SUBJECT TO RETENTION IN ACCORDANCE WITH THE LOCAL GOVERNMENT'S REQUIREMENTS

NOTES
 THE DRAWING IS FOR INFORMATION AND IS NOT TO BE USED FOR CONSTRUCTION WITHOUT THE WRITTEN PERMISSION OF FENDER KATSALIDIS (AUSTRALIA) PTY LTD
 THIS DRAWING IS NOT TO BE USED FOR CONSTRUCTION WITHOUT THE WRITTEN PERMISSION OF FENDER KATSALIDIS (AUSTRALIA) PTY LTD
 THIS DRAWING IS NOT TO BE USED FOR CONSTRUCTION WITHOUT THE WRITTEN PERMISSION OF FENDER KATSALIDIS (AUSTRALIA) PTY LTD
 THIS DRAWING IS NOT TO BE USED FOR CONSTRUCTION WITHOUT THE WRITTEN PERMISSION OF FENDER KATSALIDIS (AUSTRALIA) PTY LTD

SCALE 1:1 @ A1

PROJECT PROPOSED RESIDENTIAL DEVELOPMENT
ADDRESS 130 JOYNTON AVENUE, ZETLAND

CLIENT DECORP
DESIGNER RESILVY & SPRESSER
ARCHITECT FENDER KATSALIDIS (AUSTRALIA) PTY LTD
CONTACT 131, 250 GEORGE STREET, SYDNEY NSW 2000, AUSTRALIA
 TELEPHONE: +61 2 8210 3300
 FAX: +61 2 8210 3300
 WEBSITE: WWW.FK.AU
DATE 23/09/24

